

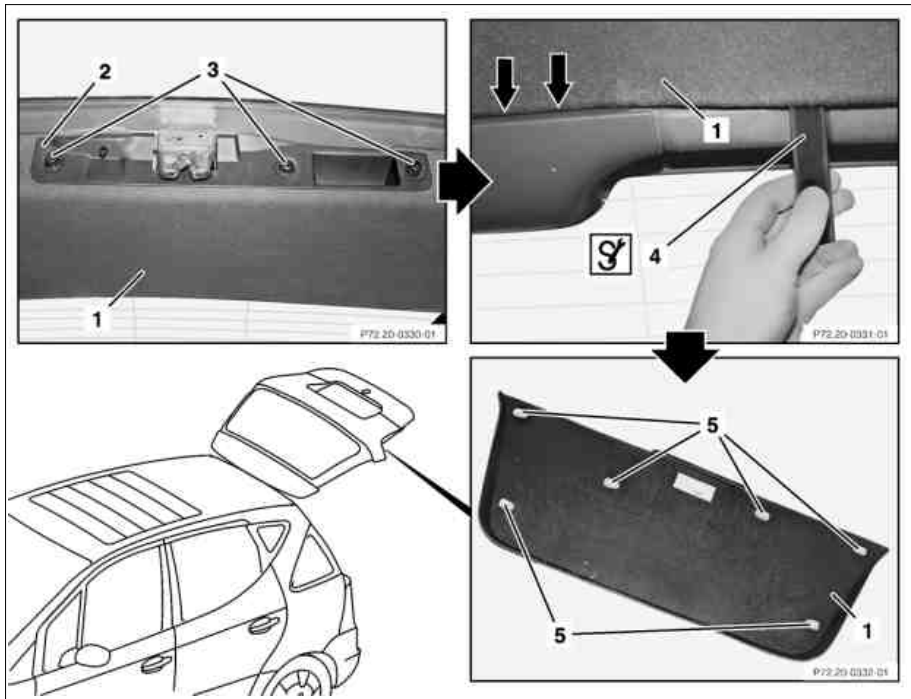







MODEL 168

- 1 Door trim panel
- 2 Cover
- 3 Clips
- 4  Long wedge
- 5 Clips

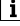

P72.20-0329-06

 	Removing, installing		
1	Remove clips (3) on the cover (2)	<div> Pry out spreading pin of individual clips with longitudinal wedge</div> <div></div>	*115589035900
2	Remove cover (2)		
3	Press off liner (1) on inner tailgate panel all around with long wedge (4)	<div></div> <div>Move longitudinal wedge directly to each of the clips (5)</div>	*115589035900
4	Remove liner (1)	<div> Installation: Slide door lining first under the cover (arrows), then press in at the clips (5)</div>	
	Inspecting		
5	Check clips (3, 5)	<div> Replaced damaged clips</div>	
6	Install in the reverse order		

