

AZ54.65-P-0001-03A	Installing, connecting sensors	Models 140, 163, 168, 170, 202, 208, 210, 220	
--------------------	--------------------------------	---	--

i Two different trim ring versions are included in the vehicle kit for models 210 and 208. Use four trim rings with part no. 0 263 009 067 on models 210.0/6 and 208. Use two trim rings with part no. 0 263 009 067 and two with part no. 0 263 009 044 on model 210.2. Trim rings with part no. 0 263 009 044 must be used on the installation housings of the outer sensors and those with part no. 0 263 009 067 on those of the inner sensors.

- 1 Unless already preassembled, clip trim rings (5) onto the installation housing (4).
- 2 Push isolation ring (3) onto the sensors (2) and insert sensors into the installation housing.
- i** Pay attention to installed position of sensors. The electrical connections must point towards the center of the bumper if possible.
- 3 Insert installation housing with trim ring and sensor in the bumper and press on retaining spring (1) until it locks in position audibly.

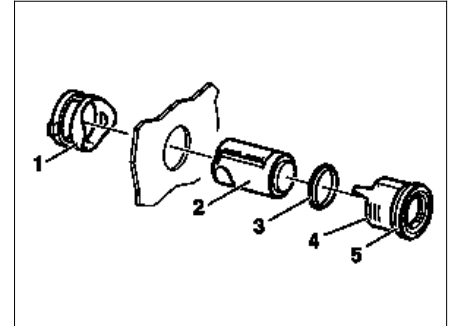

P54.70-2081-01

- 4 Connect sensor wiring harness to the sensors starting with connector 1 on the right in the direction of travel and route wiring harness on the inside of the bumper.
- i** Pay attention to chafe-free routing of the sensor wiring harness. If possible attach wiring harness to the bumper or to the inner section of the bumper using cable straps.
- 5 If removed, insert the inner section of the bumper or impact member in the bumper again.

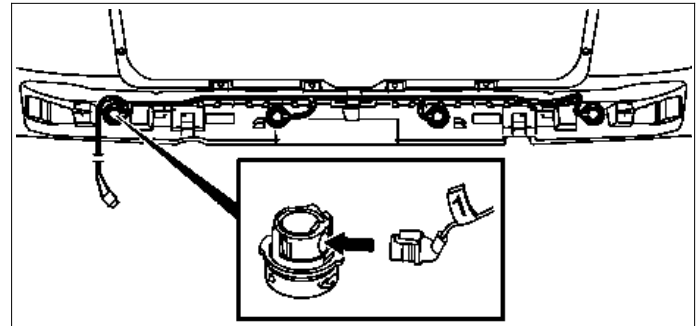

S54.65-0012-10

- 6 For routing the connection cable of the sensor wiring harness in the trunk or loading space, if necessary select an existing cable bushing in the rear area or make a 24 mm dia. hole at a suitable point in the rear panel.
- i** Protect subsequently made hole against corrosion. Seal hole with a rubber grommet when routing the cable.