

## 42-0525 R and R rear brake cable control

### Preliminary work:

Remove parking brake shoes (42-0530).

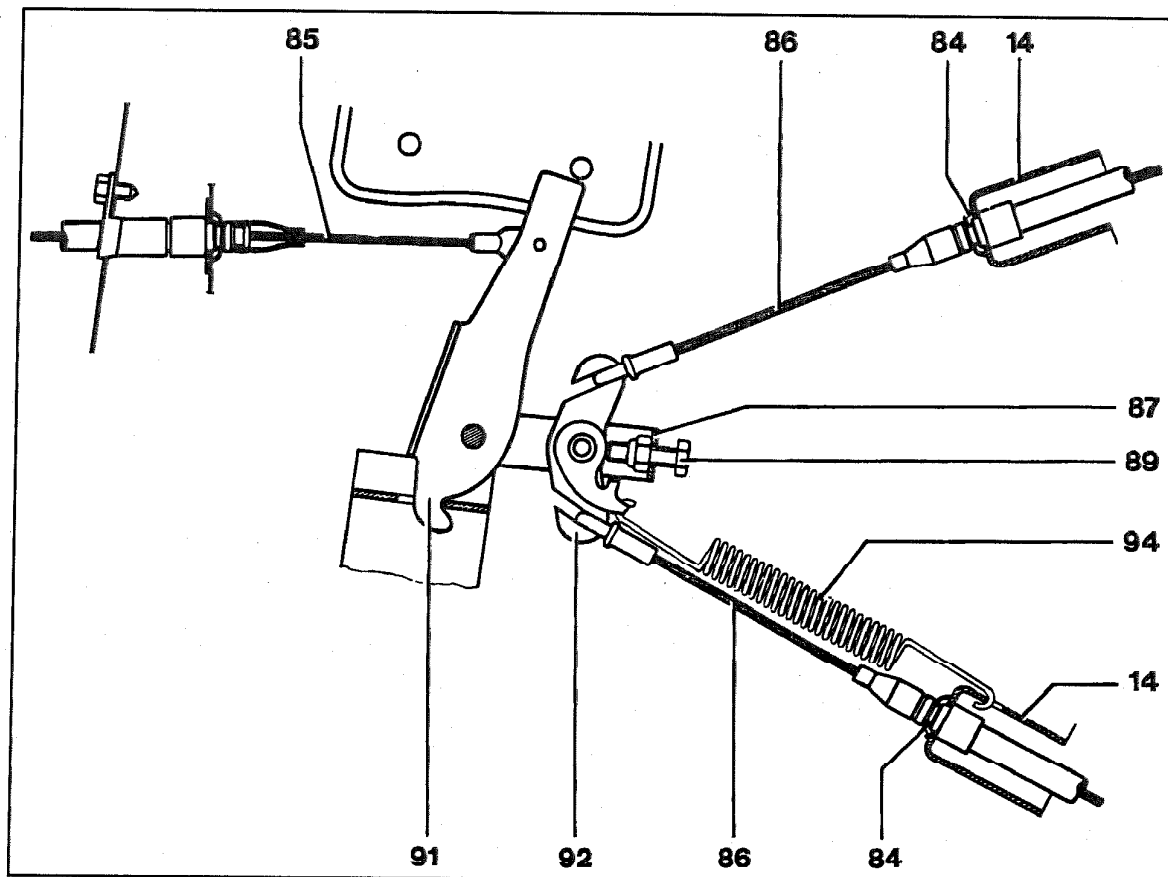

P42-0255-57

Brake control cable (86) .....	screw off of wheel carrier and remove.
Return spring (94) .....	unhook from mount (14), hook in and turn back adjustment screw (89) on adjustment bracket.
Intermediate lever (91) .....	unhook at bearing on frame floor and remove from adjustment bracket (1).
Brake control cable (86) .....	unhook from compensation lever (7), hook in.
Spring clip (84) .....	remove, install. Pull control cable out of mount (14) toward rear and through rubber sleeve in semi trailing arm.

### Special tools

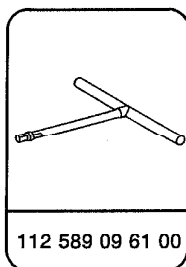
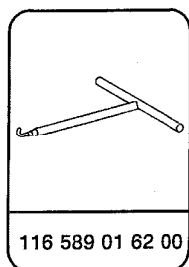

### Removal, installation

- 1 Screw bolt (98) out of wheel carrier (49) and remove brake control cable (10).

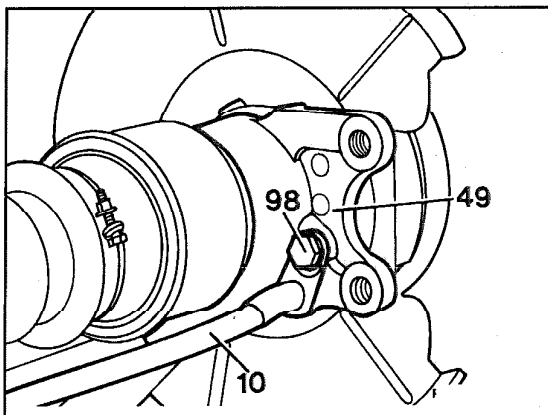

### Note

On vehicles with anti-squat control screw both bolts (98) out of wheel carrier and remove brake control cable (10).

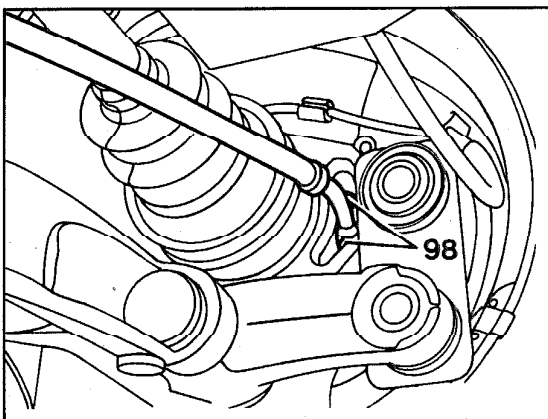

## 42-0525 R and R rear brake cable control

- 2 Unhook return spring (12) from mount (14) and turn adjustment screw (3) back on adjustment bracket (1).
- 3 Unhook intermediate lever (6) on bearing on frame floor and remove from adjustment bracket (1).
- 4 Unhook brake control cable (10) from compensating lever (7).

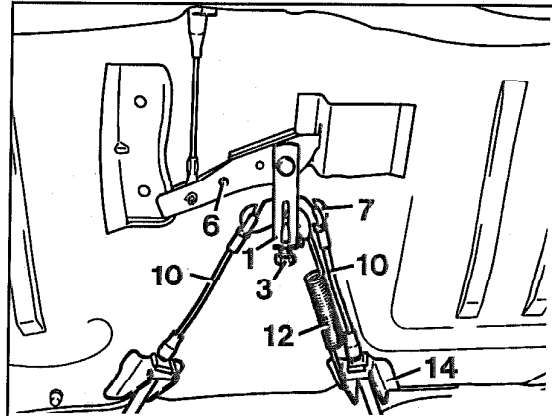

P42-2180-13

- 5 Remove spring clip (13), remove control cable (10) from mount (14).
- 6 Pull brake control cable out toward rear through rubber sleeve (45) in semi trailing arm.

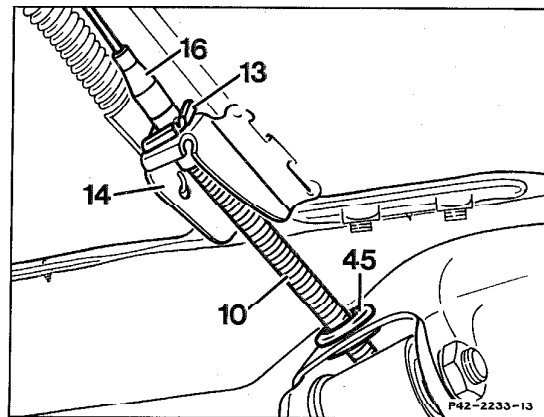

P42-2233-13

### Installation note

Assure that the rubber sleeves (16) are not damaged.